

Waterproof connector installation guide

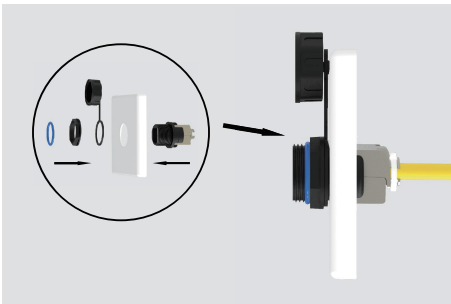

1. Assemble and tighten in sequence as shown in the figure. Seal with dustcover until ready for use

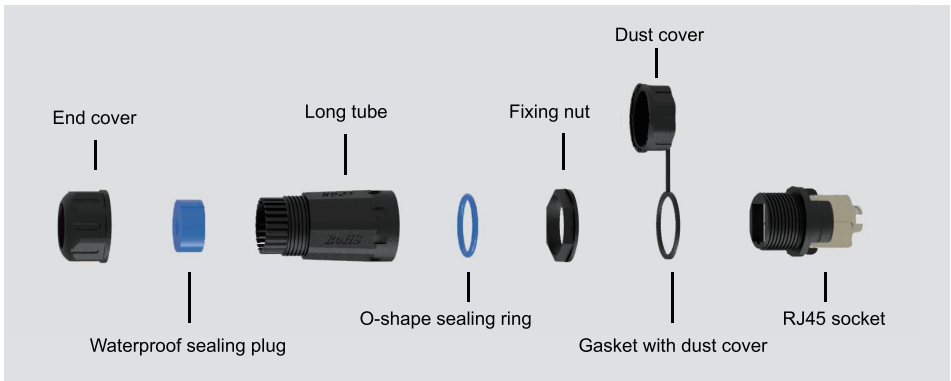
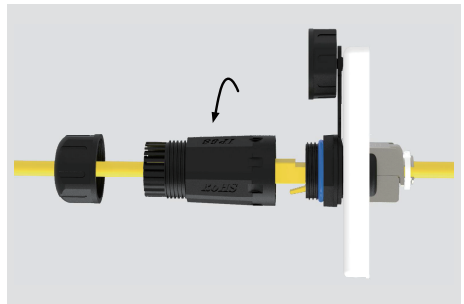

2. Pass the patch cord through the end cover and the long tube. Then insert the connector. Tighten the long tube.

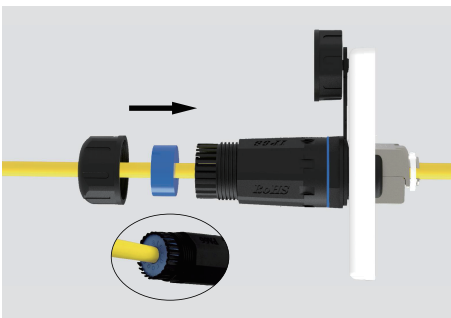

3. Lock the waterproof plug on the cable, then put it into the end of the long tube. Note: The plug is engraved with the word "waterproof" on one side outward.

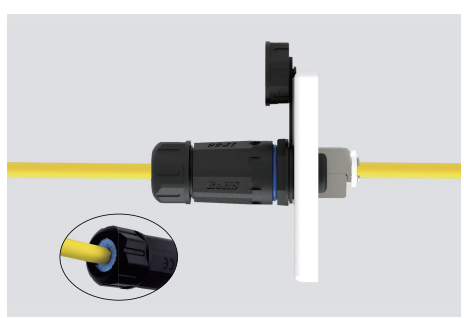

4. Screw the end cover onto the long tube. Finally check whether the waterproof plug has a good fit with the cable.